

SKETCH : BLANKING DIMENSIONS FOR TPS-TECHNISEAL CONNECTIONS

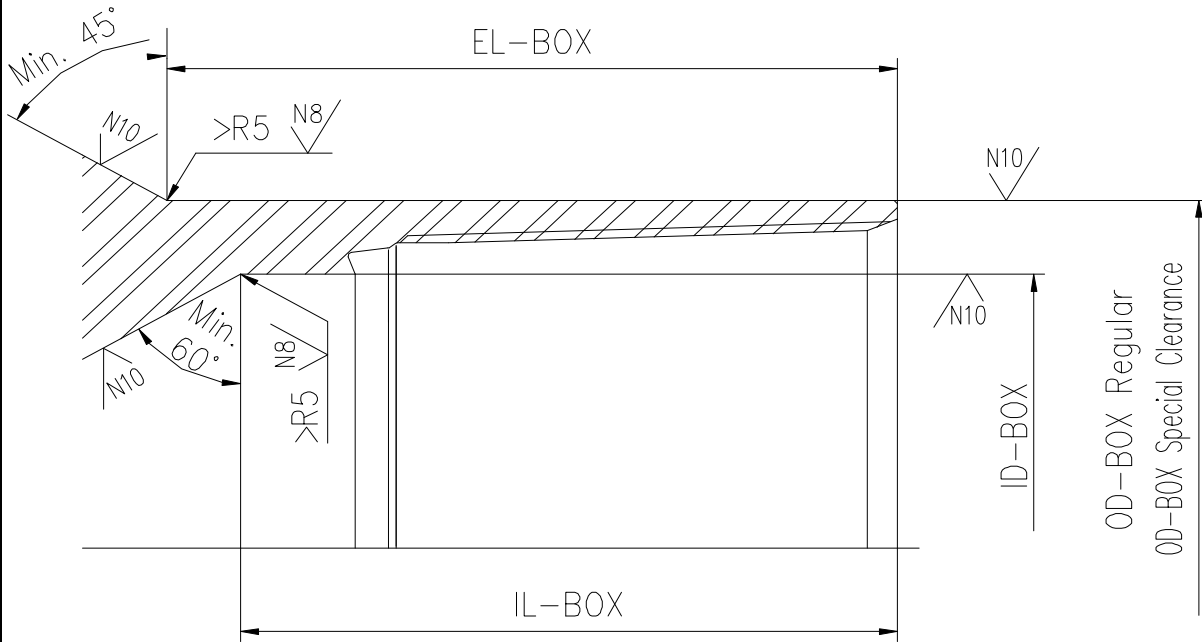

$\sqrt{N10}$ → $Ra=12,5\mu m, Ra=500\mu in$
 $\sqrt{N8}$ → $Ra=3,2\mu m, Ra=125\mu in$

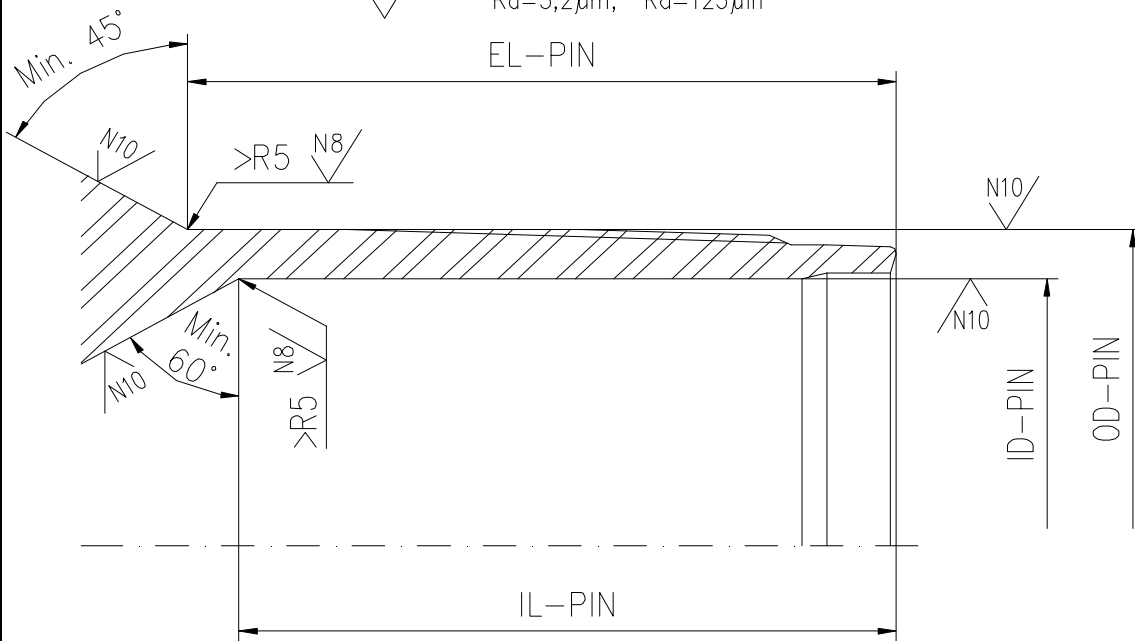

Remark: Connection areas shall be machined coaxial